

996 GT3 Front Sway Bar Drop Link Attachment Bracket - Installation and Use

Part #: 2271008

Cars applicable:

996 all

Parts list:

Quantity	Description
2	GT3 Front Sway Bar Drop Link Brackets (L/R)
4	M19 spacers
2	M12 x 120 Bolts
4	M12 Washers
2	M12 Lock nuts

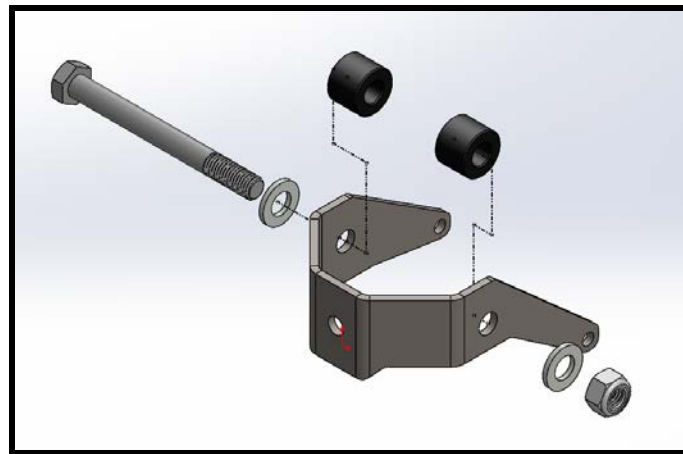

GT3 Drop Link Attachment Bracket

Tools Required:

- Basic Mechanic's Tool set

Introduction:

Congratulations on your purchase of the Elephant Racing GT3 sway bar drop link bracket. This bracket allows the use of the 996 GT3 front sway bar by creating a drop link attachment point on the wheel upright in the same location as on the GT3. This kit can be used with either the factory GT3 drop links, or adjustable links (recommended) available directly from Elephant Racing.

Attaching the drop link in the factory GT3 location provides the maximum possible range of motion of the drop link rod ends, thus preventing damage caused by binding at extreme joint angles.

Step-by-Step Instructions:

1 – Safely raise and secure the vehicle, then remove the front wheels.

2 – Loosen and remove the M6 bolts holding the wheel speed sensor electrical connector and brake line bracket to the wheel upright. Passenger's side shown to the right.

Wheel Speed Sensor Connector



Brake Line Bracket Attachment Point



3 – Place a jack or other supporting device underneath the lower control arm.

4 – With the lower control arm properly supported, loosen and remove the bolt clamping the strut to the wheel upright.

5 – Slide the Elephant Racing Drop Link Bracket over the wheel upright. Attach the bracket to the upright using the previously removed M6 bolts. Do not tighten more than finger tight.

6 – Attach one end of the sway bar drop link to the bracket.

7 – Install one 19mm spacer in each circular cutout on the wheel upright clamp. While holding the spacers in place with one hand, swing the drop link bracket down over the spacers to hold the spacers in place.

Wheel Upright
Circular Cutout



8 – Install the provided M12 bolt through the bracket, spacers, and strut clamp. Install the provided lock nut and tighten finger tight.

9 – Remove the factory front sway bar and install the GT3 sway bar. Refer to an appropriate service manual for detailed instructions.

10 – Attach the drop link to the sway bar at the desired location on the GT3 sway bar.

11 – Torque all fasteners to the proper specifications per an appropriate service manual.

12 – Re-install the wheels and lower the car. Test drive the car to ensure all fasteners and components are tight and working as intended.



This page intentionally left blank.